

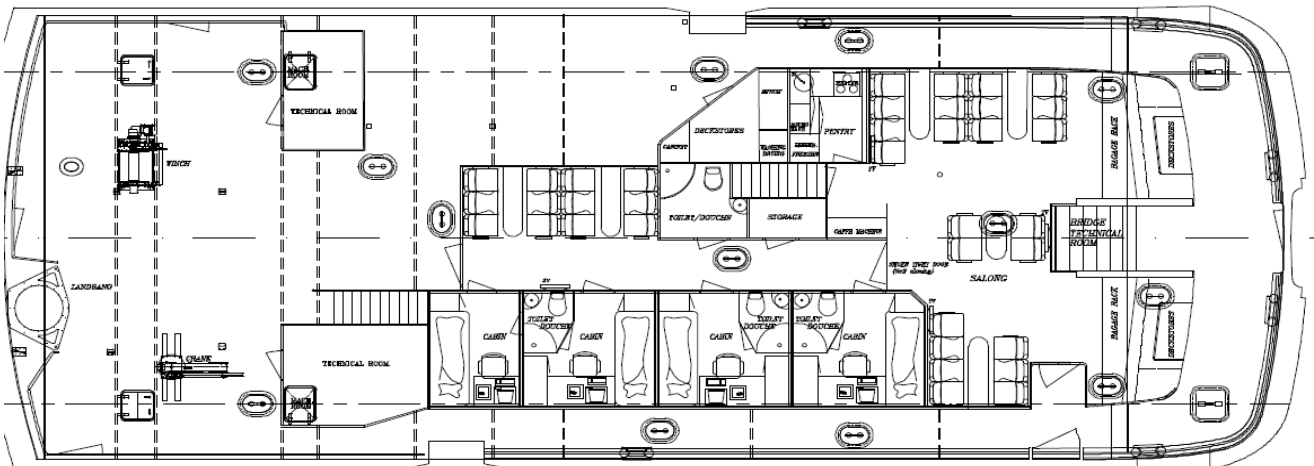

Fob Swath 1

CREW TRANSFER VESSEL

Vessel Specification

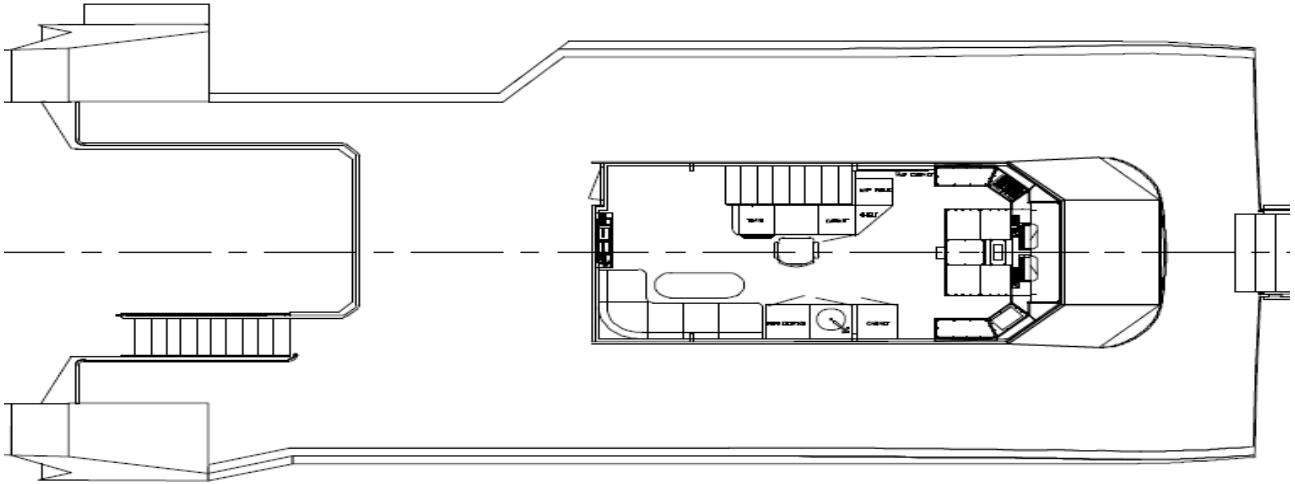

Nordsoekaj 51, DK 7680 Thyboroen - Tel/24.hrs duty phone +45 97 88 80 00

www.odfjellwind.com ows@odfjellwind.com



Fob Swath 1

CREW TRANSFER VESSEL

Vessel Specification



REGISTRATION

Name	M/V Fob Swath 1
Owner	Offshore Windservice A/S
Year built / Upgrading	2014-2015 / 2020
Flag	Danish
Classification	DNV-GL 1A1 HSCLC CREW R1
Home Port	Thyboroen
ISM / MLC	DNV-GL Certified
ISO 9001 & 14001 & 45001	SWEDAC / A3cert

MAIN CHARACTERISTICS

Length overall	27,00 m
Length between P. P	23,32 m
Breadth moulded	9,60 m
Depth moulded	4,40 m
Draft max CAT/SWATH	1,70 / 2,50m
Gross Tonnage	155
Net Tonnage	47

PROPULSION

Main Engine	2x 810 kW MAN Diesel
CPP	2x Servogear
Gear	2x Servogear
Generators	2 x 75 kW John Deere

BUNKERS

Fuel Tanks - Daily operations	6 Cub. M.
Fuel Tanks - Weekly operations	12,3 Cub. M.
Provided with equipment for Offshore Bunkering	
Freshwater	3 Cub. M

PERFORMANCE

Maximum Speed	18-19 knots
Service Speed	17-18 knots

ACCOMMODATION

Crew for 12Hrs/24hrs: 3/4 crew
Totally 24 passengers
Fully air-conditioned
Coffee & water for passengers
1x Toilets & Shower for passengers
Satellite TV & Internet (Satellite internet if required)

DECK EQUIPMENT

1x Crane TMP700K Max 700kg on outreach 7m & 1470kg on outreach 2,5m
1x Dacon rescue net (One person to operate from deck)

NAVIGATION/COMM. EQUIPMENT

2x Furuno – Fully operative ECDIS System incl. Backup.
2x Furuno Radar/ARPA
2x Furuno GPS GP-150 / 1x Furuno AIS FA-150
2x VHF JRC NCM-1770 / 1x MF-HF JRC 2150
2 x EPIRP / 1x SART
Furuno FE-800 echosounder / Furuno SC-50 THD
Satellite compass / Furuno DS-80 speed log
Furuno WS-200 Weather station
A1+A2 Radio Station (A3 if required)
V-Sat for phone, email, data
GSM Mobile telephone

LIFE SAVING EQUIPMENT

2x MES for each 39 persons Incl. SOLAS Pack B
Firefighting equipment according to HSC Code 2000 / Regulations
Life Saving appliances according to HSC Code 2000 / Regulations

Nordsoekaj 51, DK 7680 Thyboroen - Tel/24.hrs duty phone +45 97 88 80 00

www.odfjellwind.com ows@odfjellwind.com